



Fuellmeister.de

Packer Engineering for Containers and Packs

Packer Engineering

most stable of value...



MultiPac I

Füllmeister GmbH & Co. KG

Am Mühlbach 1

97475 Zeil am Main

Tel.: 0049 (0)9524 - 300 477

Fax.: 0049 (0)9524 - 300 0262

Mobil: 0049 (0)175 - 4018947

e-Mail: info@fuellmeister.de

Homepage: www.fuellmeister.de



Product Lineup

- Breweries
- Mineral Waters
- Softdrinks
- Fruit Juices
- Spirituos Liquors
- Wine
- Food + Non-Food



- Packer
- Unpacker
- Sorting Packer
- Multi-Function
- Re-Packing

"Gripping" Features

MP

PackerEngineering

Packing In - Packing Out

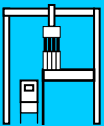
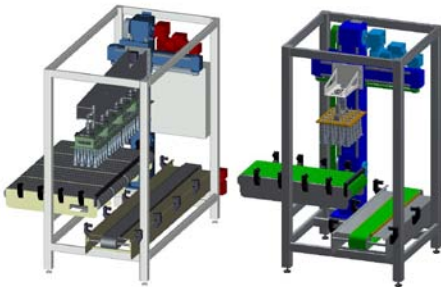
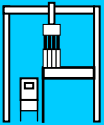
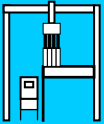
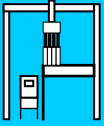

- solid base frame construction
- linear guides with tooth belt drive
- horizontal and vertical axes
- energy saving drives with counterweight
- stainless construction
- tooth belt drive for bottle table with **VarioDrive-System**

- little floor space required
- multi function possible
- basic unit with attached switchboard, stainless
- packing in and out
- for containers, trays and packs
- payload from 5 kg to 400 kg

- gripper head combination
- long life packing tulips
- packer head shutdown within 1/10 sec
- changeover within minutes without tools
- low energy cost by counter weight
- H and T bottle tables
- sorting unpacker

- command display at maintenance side
- removable packer head unit
- touch-screen control
- efficient and renowned German assemblies, e.g.:
 - o Siemens S7
 - o maintenance panel OP 3
 - o Klöckner Moeller
 - o Bosch or Festo
 - o SEW

NH26.12.07

electrical connections		packer heads		block length		capacity
potential	axes	min.	max.	min.	max.	strokes/lifting
230/400V 50 Hz	1 - 3	1	5	300	1.600	150 - 450